

OptimizeHIT User Guide for Mobile Application

Doctors Hospital at Renaissance Health Systems has partnered with AHIMA to deliver to you ICD-10 e-learning training platform via the OptimizeHIT mobile application. This application will give you guidance on all specialties: diagnosis, procedures and documentation in relation to your patient's condition. This application will also earn you CME credits (AMA PRA Category 1 Credit(s))

Installing OptimizeHIT in Android device

1. Download the app by typing in OptimizeHIT in Google Play Store.

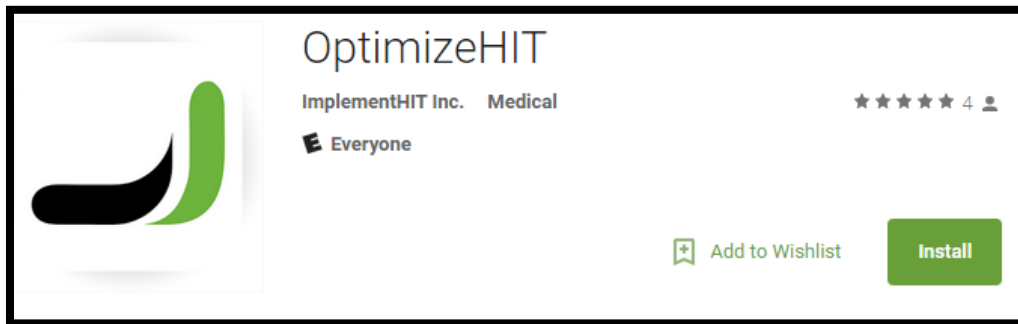

2. Once the app has downloaded click open.

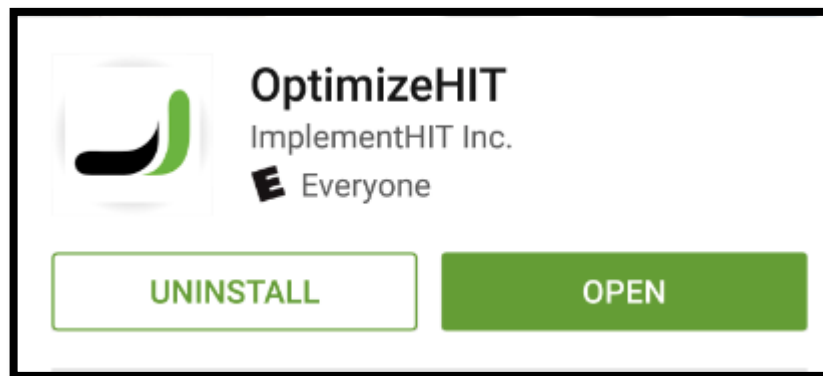

3. The next window will prompt you to accept location, photos, and microphone. Click **ACCEPT**.

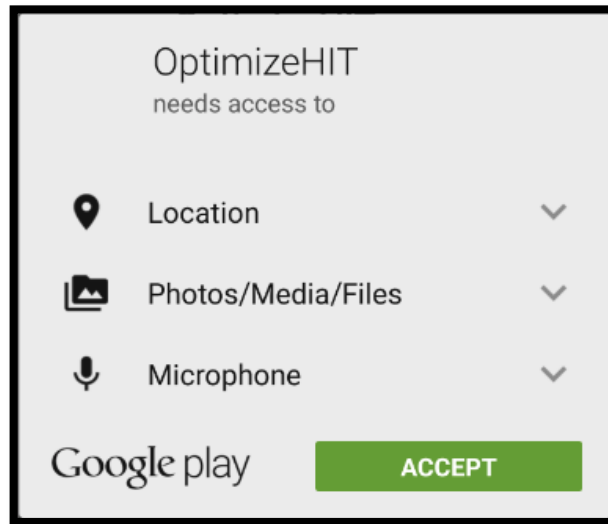

4. The app will now prompt you to enter login information.

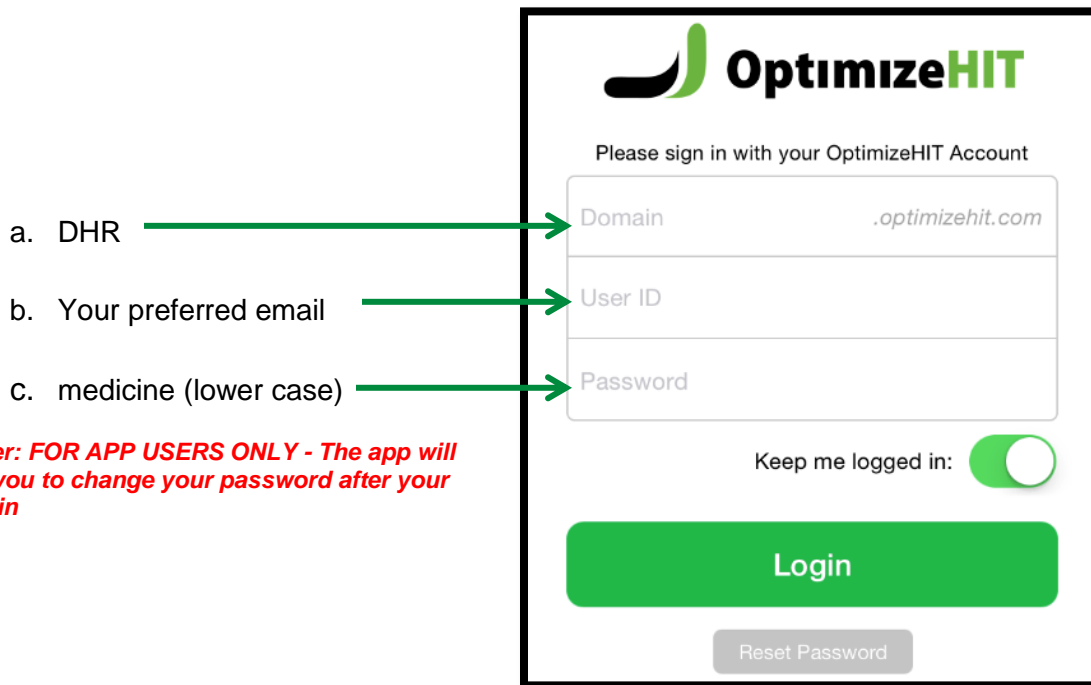

Reminder: FOR APP USERS ONLY - The app will prompt you to change your password after your first log in

- ❖ You can choose to have the app remember your credentials and keep you logged in, doing so will mean you need not enter your information every time you open the application.
- ❖ Once you have filled in the information, press Login and continue.

OptiQuery™

OptiQuery™ is the primary section and the default screen of the OptimizeHIT app. You can gain access to the solution library using 3 methods.

- ❖ By typing in your question into the text field
- ❖ By using the Voice Search feature (press the microphone and say your question)
- ❖ By browsing through available solutions

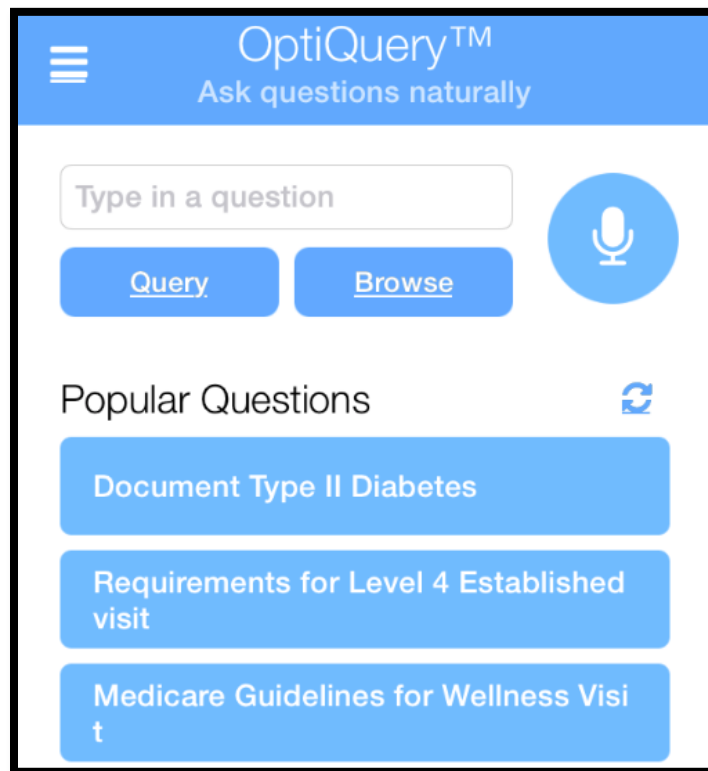

Typing in your Query

Type your query in the text field → Next press the Query button to begin your search. Your query will provide you with Key Documentation Tips or give you a list of choices to select from if the search requires more detail information.

Using Voice Search

The OptimizeHIT app has a built in speech recognition feature to help you look for solutions.

- ❖ Press the microphone button to begin the query search.
- ❖ After the beep speak
- ❖ After a brief pause the app will automatically search the query.

Browse through the Solution Library

You browse through the solution library by clicking the Browse button on the OptiQuery™ page. It will take you to the Categories page where you can choose one of the following

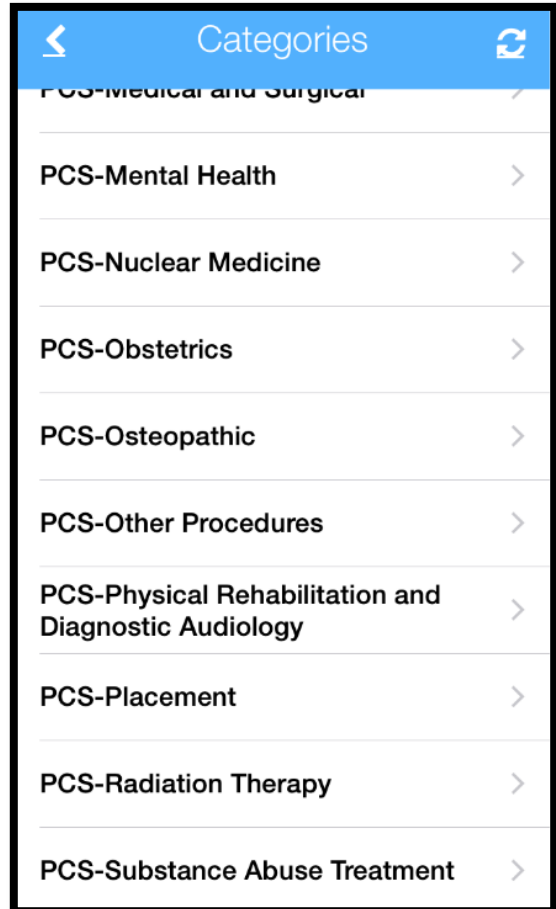
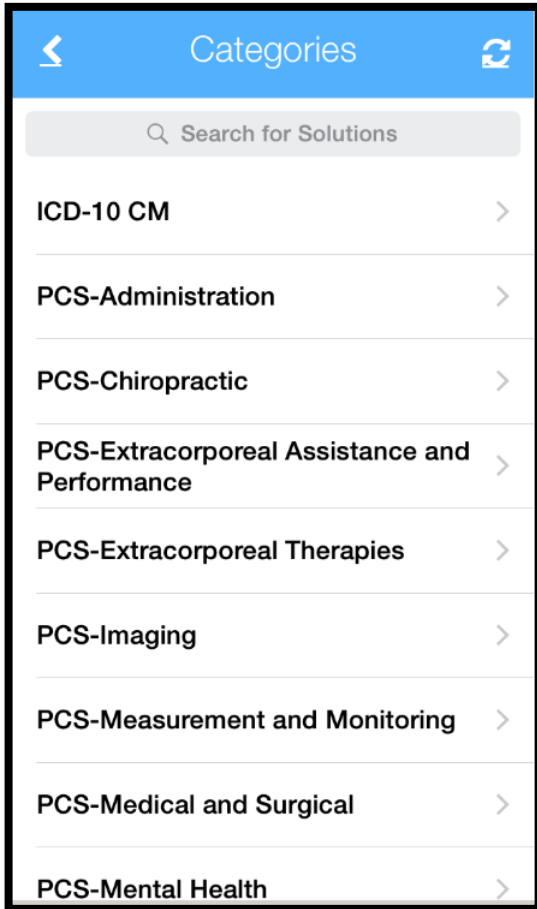

The main menu icon can be accessed at the top left corner. Some of the available features are favorites, history, settings, and log out option.

Main Menu Icon

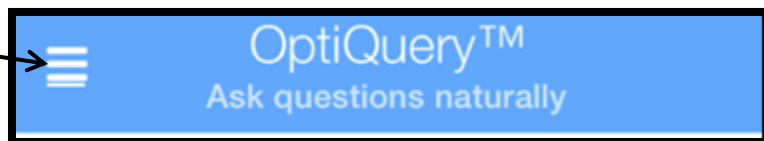

Main Menu

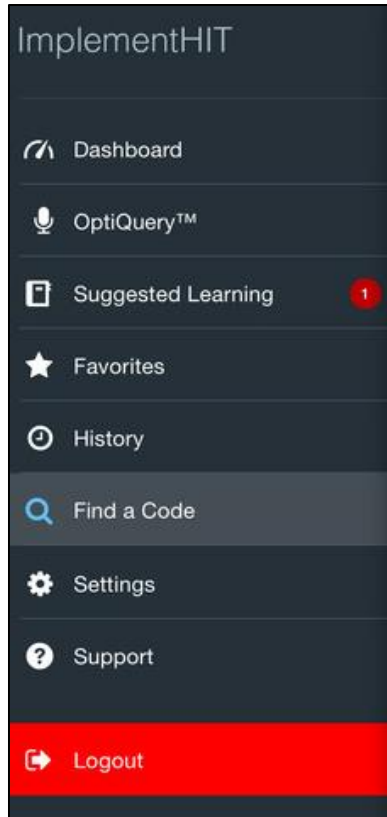

Option will track application usage and change over time depending on usage.

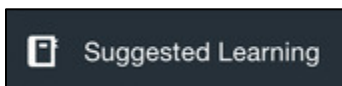

Will give you suggestions based on your frequent or recent searches pertaining to your preference.



Will allow you to view favorite items that you have saved into that category for later use.



Will allow you to view recent searches.



Options is to change your preference in terms of what you want your default screen to be, the ability to auto start the auto play back option, and the speed of the reading voice.



Enables you to log out of the Optimize application when you are finished.



For general OptimizeHIT application questions or comments, please contact the technical support desk at 844-839-1943 between 8:00 AM – 5:00 PM CT Monday – Friday. A support ticket may be opened at any time by